



慈溪网通电子有限公司

CiXi WangTong Electronic Co.,Ltd

产 品 规 格 书

Product Specification

产品名称： WT15型连接器

拟制：

审核：

批准：

ADD:浙江省慈溪市匡堰东工业区

TEL:0574-23618678

FAX:0574-63535838

WEB:www.dipswitches.cn

商品名称：WT15型连接器



型号标志代号

Part number system

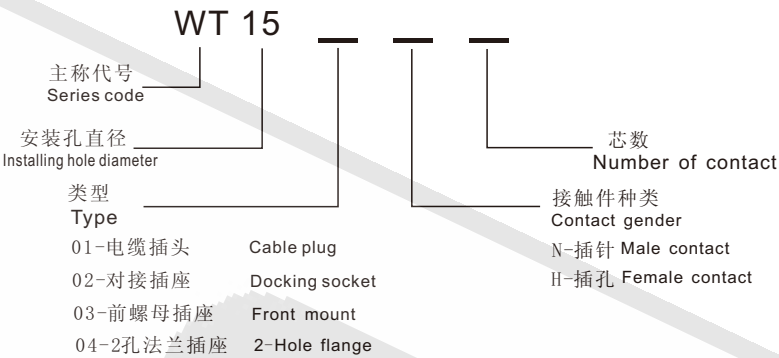

商品详细信息

IP67 Threaded Coupling

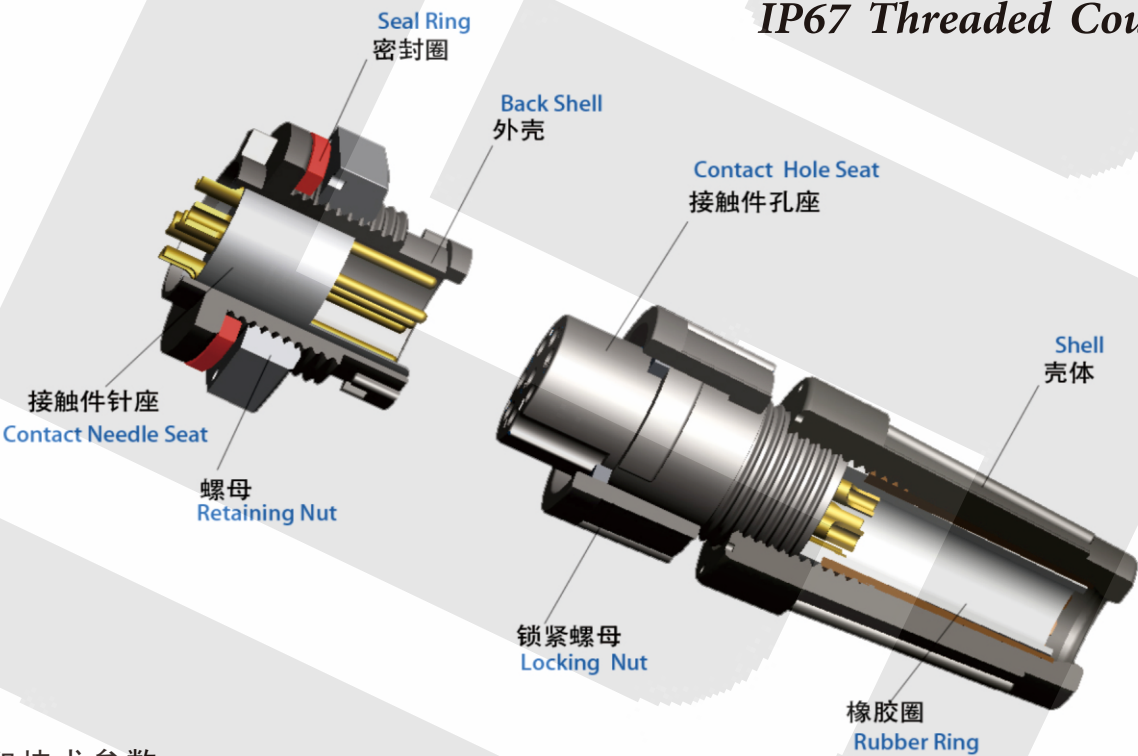

材料和技术参数

Material and spec

接插方式	Coupling	快速锁紧	Threaded coupling
外壳材料	Shell material	热塑塑料 PA66	Nylon 66 .
绝缘体材料	Insert material	热塑塑料 PA66	Nylon 66
接触件材料	Contact material	铜镀金	Gold-plated copper
接触方式	Termination	WT15：焊接	WT15 :solder
电缆直径	Cable diameter	WT15：4-6.5MM	
防护等级	IP rating	IP 67	
接插次数	Mating cycle	>500次	
温度范围	Temperature range	-25℃ ~+85℃	
绝缘电阻MΩ	Insulation resistance MΩ	>2000	



WT1501H

电缆插头 Cable plug

与 WT1502, WT1503, WT1504 相配
Match with WT1502, WT1503, WT1504

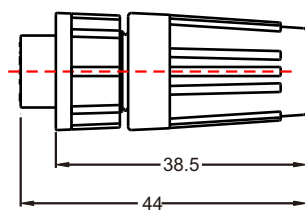
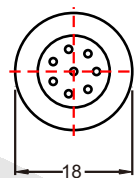

WT1502N

对接插座 Docking socket

与 WT1501 相配
Match with WT1501

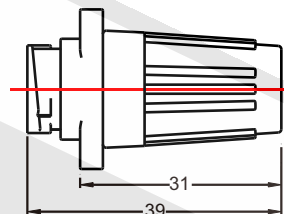
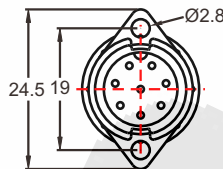

WT1503N

前螺母插座 Front mount

与 WT1501 相配
Match with WT1501

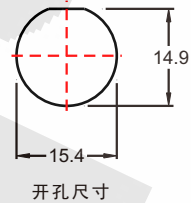
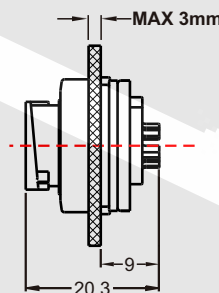
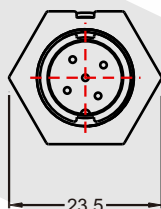

WT1504N

2孔法兰插座 2-Hole flange

与 WT1501 相配
Match with WT1501

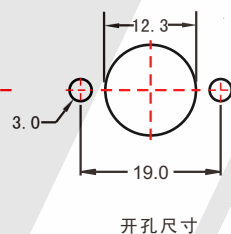
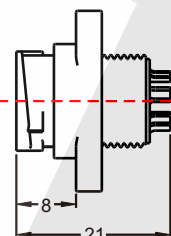
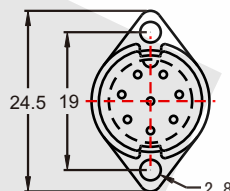

芯数排列及技术特性表 Contact arrangement and spec

芯数 Number of contact	2	3	4	5	6	7	8
插针绝缘体正面图 Male contact face view							
额定电流A Rated current (A)	5A	5A	5A	5A	5A	5A	5A
接触件径 Contact diameter	Ø1X2	Ø1X3	Ø1X4	Ø1X5	Ø1X6	Ø1X7	Ø1X8
工作电压 (AC.V) Rated voltage (AC.V)	200V	200V	200V	180V	180V	180V	180V
耐压 (AC.V) 1min Test voltage (AC.V) 1min	1500V	1500V	1500V	1000V	1000V	1000V	1000V
接触电阻 mΩ Contact resistance mΩ	10	10	10	10	10	10	10